

STATE OF NEW MEXICO
COUNTY OF ROOSEVELT

RESOLUTION 2015-64
PARTICIPATION IN LOCAL GOVERNMENT ROAD FUND PROGRAM ADMINISTERED
BY NEW MEXICO DEPARTMENT OF TRANSPORTATION

WHEREAS, the Roosevelt County and the New Mexico Department of Transportation enter into a Cooperative Agreement.

WHEREAS, the total cost of the project will be \$123,636.00 to be funded in proportional share by the parties hereto as follows:

- a. New Mexico Department of Transportation's share shall be 75% or \$92,727.00
- and
- b. **Roosevelt County's** proportional matching share shall be 25% or \$30,909.00

TOTAL PROJECT COST IS **\$123,636.00**

Roosevelt County shall pay all costs, which exceed the total amount of **\$123,636.00**

Now therefore, be it resolved in official session that Roosevelt County determines, resolves, and orders as follows:

That the project for this Cooperative agreement is adopted and has a priority standing.

The agreement terminates on **December 31, 2016** and the Roosevelt County incorporates all the agreements, covenants, and understandings between the parties hereto concerning the subject matter hereof, and all such covenants, agreements and understandings have been merged into the written agreement.

NOW therefore, be it resolved by the Roosevelt County to enter into Cooperative Agreement Project Number SP-2-16(908), Control Number L200269 with the New Mexico Department of Transportation for LGRF Project for year **2015 – 2016 for caliche rehabilitation of one and three-quarters of a mile on SRR 9 between US 70 and SRR U; one and one-quarter mile on SRR 5 between NM 88 and SRR M; one mile on SRR 9 1/2 between SRR P and SRR Q; and one mile of SRR S between SRR 9 and SRR 10** within the control of the Roosevelt County in Roosevelt County, New Mexico.



PRESENTED, ADOPTED, APPROVED and RECORDED this 1st day of September, 2015.

BODY OF COUNTY COMMISSIONERS
ROOSEVELT COUNTY, NEW MEXICO

ATTEST:





DeAun D. Searl, Roosevelt County Clerk



Vacant – District V

Jake Lopez, Vice-Chair – District I



Gene Creighton – District IV

Richard Leal – District II

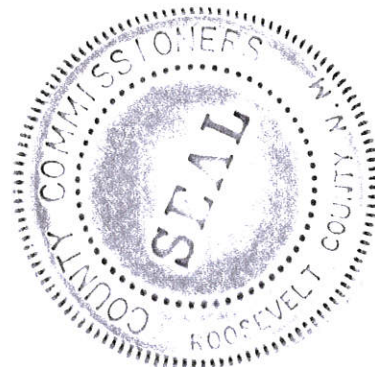
Lewis (Shane) Lee – District III

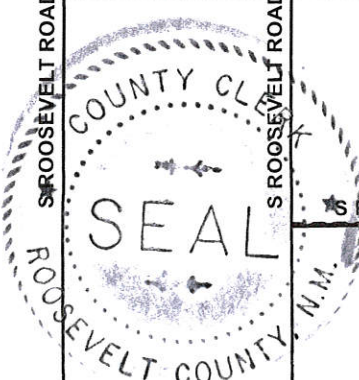
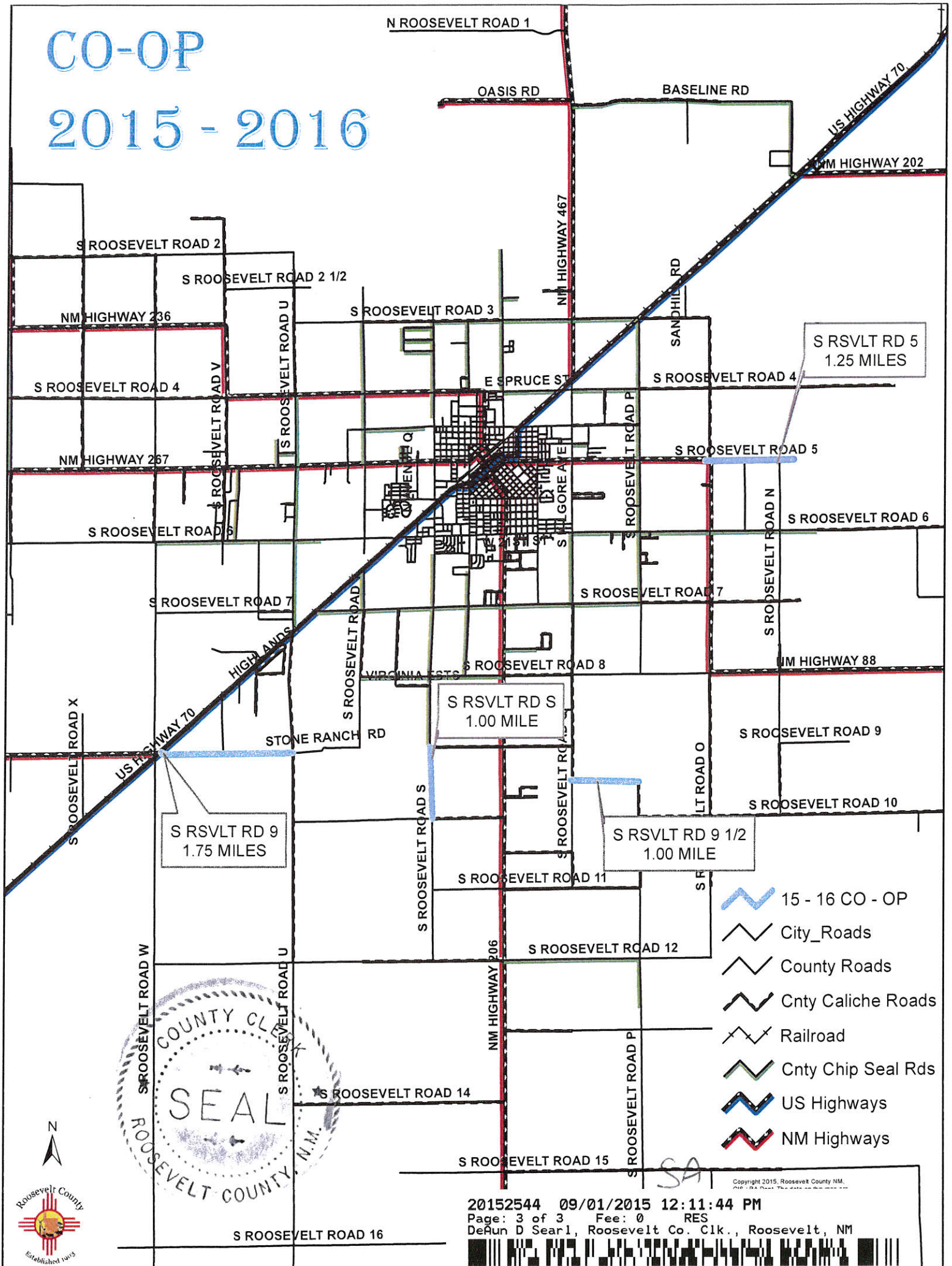

CO-OP 2015 - 2016



- 15 - 16 CO - OP
- City_Roads
- County Roads
- Cnty Caliche Roads
- Railroad
- Cnty Chip Seal Rds
- US Highways
- NM Highways

